

VERIN PLONGEUR TYPE "HFRT"
PLUNGER CYLINDER "HFRT" TYPE

Series M250

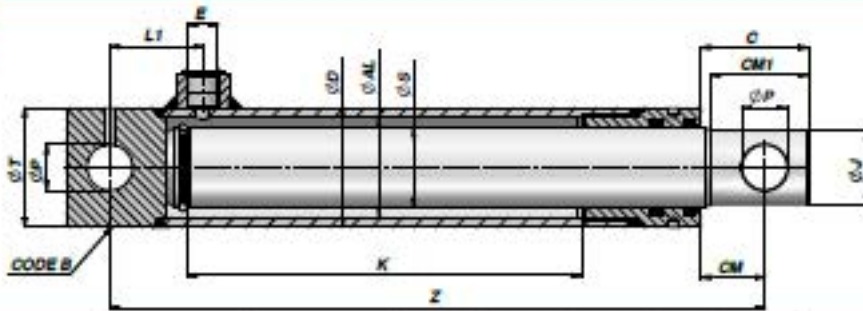

Code Code	K	Z	kg	E BSP	L1	ØP	CM	C	ØJ	CM1	ØT	Code B
ØD 40 ØAL 30 ØS 25												
HFRT125100	100	190	1,64	3/8"	40	14,10	24	38	22	35	40	CFHR030014030
HFRT125150	150	240	2,05									
HFRT125200	200	290	2,46									
HFRT125250	250	340	2,87									
HFRT125300	300	390	3,28									
ØD 50 ØAL 40 ØS 30												
HFRT230200	200	300	3,64	3/8"	42	16,20	26	42	27	37	50	CF04005016
HFRT230250	250	350	4,19									
HFRT230300	300	400	4,74									
HFRT230350	350	450	5,30									
HFRT230400	400	500	5,85									
HFRT230550	550	650	7,52									
HFRT230700 NEW	700	800	9,18									
ØD 60 ØAL 50 ØS 40												
HFRT340200	200	330	6,08	3/8"	47	23,10	32	54	37	49	60	CFHR050023050
HFRT340250	250	380	6,91									
HFRT340300	300	430	7,75									
HFRT340350	350	480	8,58									
HFRT340400	400	530	9,41									
HFRT340550	550	680	11,90									
HFRT340700	700	830	14,40									
ØD 60 ØAL 50 ØS 45												
HFRT345200 NEW	200	330	6,73	3/8"	47	23,10	34	56	42	49	60	CFHR05023050
HFRT345250 NEW	250	380	7,69									
HFRT345300 NEW	300	430	8,66									
HFRT345350 NEW	350	480	9,62									
HFRT345400 NEW	400	530	10,58									
ØD 70 ØAL 60 ØS 50												
HFRT450300	300	460	11,40	3/8"	50	25,50	49	74	47	65	65	CFHR07060
HFRT450400	400	560	13,74									
HFRT450550	550	710	17,25									
HFRT450700	700	860	20,77									
ØD 80 ØAL 70 ØS 60												
HFRT560200 NEW	200	360	12,26	3/8"	50	25,25	36	61	57	57	75	CFHR08070
HFRT560300 NEW	300	460	15,40									
HFRT560400 NEW	400	560	18,53									
HFRT560550 NEW	550	710	23,24									
HFRT560700 NEW	700	860	27,95									
ØD 92 ØAL 80 ØS 70												
HFRT570300 NEW	300	509	22,66	3/8"	55	30,25	66	96	67	90	85	CFHR09080
HFRT570400 NEW	400	609	26,94									
HFRT570500 NEW	500	709	31,23									

MATERIEL TUBE : ACIER S1 52.3 DIN 2393 ISO H9
TUBE MATERIAL : STEEL S1 52.3 DIN 2393 ISO H9

MATERIEL TIGE : ACIER UNI C45 SAE 1045 CHROME 25 µm ±5 Rating 9 / 200h ISO 10289 - 1999/ISO 9227-NSS
ROD MATERIAL : STEEL UNI C45 SAE 1045 CHROME 25 µm ±5 Rating 9 / 200h ISO 10289 - 1999/ISO 9227-NSS

CARACTERISTIQUES TECHNIQUES TECHNICAL SPECIFICATIONS

TYPE "HTO"

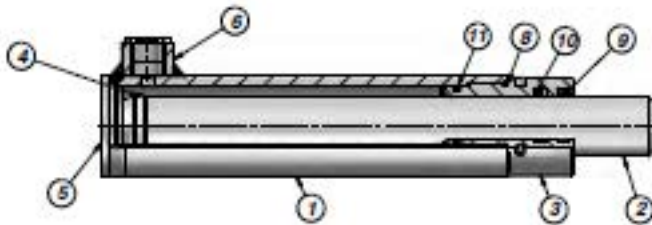

HTO Pression Maxi - Max. Pressure: 250 Bar (**)

TYPE "HFRT"

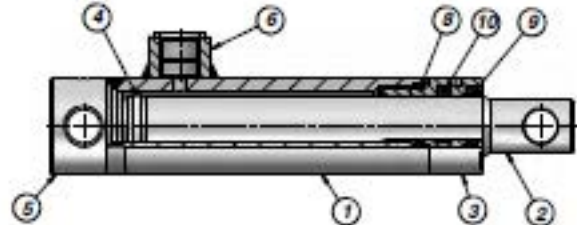

HFRT Pression Maxi - Max. Pressure: 250 Bar (**)

PRODUIT - PRODUCT			MATERIEL - MATERIAL	
1	TUBE GLACE POISHED TUBE		ACIER: STEEL:	SI 52.3 DIN 2393 ISO H9 SI 52.3 DIN 2393 ISO H9
2	TIGE CHROMEE CHROMED ROD		ACIER: STEEL:	UNIC45-SAE 1045 - CHROME 25µm±5 Rolling 9/200h (-a20 120h) ISO 10289 - 1999/ISO 9227-NSS UNIC45-SAE 1045 - CHROME 25µm±5 Rolling 9/200h (-a20 120h) ISO 10289 - 1999/ISO 9227-NSS
3	TETE DE GUIDAGE HEAD BUSH	TYPE: "HTO" TYPE: "HTO"	FONTE: HYDRAULIC CAST IRON:	EN-GJL 250 (G25-UNI 5007 / EN 1561) EN-GJL 250 (G25-UNI 5007 / EN 1561)
3	TETE DE GUIDAGE HEAD BUSH	TYPE: "HFRT" TYPE: "HFRT"	ACIER: STEEL:	9SMn28 AVEC TRAITEMENT "NI-TEMPER" 9SMn28 WITH "NI-TEMPER" TREATMENT
4	JONC D'ARRET TIGE STOP RING		ACIER: STEEL:	9SMn28 9SMn28
5	FOND END PLUG		ACIER: STEEL:	S355J0 (Fe510C) - S355JR (A105) S355J0 (Fe510C) - S355JR (A105)
6	BOSSAGE TARAUDE THREADED PORT		ACIER STEEL	
8	JOINT: SEAL:	O-RING O-RING	TYPE: "HTO" TYPE: "HTO"	NBR 70 SHORE NBR 70 SHORE
8	JOINT: SEAL:	O-RING O-RING	TYPE: "HFRT" TYPE: "HFRT"	NBR 90 SHORE NBR 90 SHORE
9	JOINT: SEAL:	GHK GHK		POLYURETHANE POLYURETHANE
10	JOINT: SEAL:	TSE-TTS-TTVL TSE-TTS-TTVL		TSE: NBR+TISSU TTS-TTVL: POLYURETHANE TSE: NBR+FABRIC TTS-TTVL: POLYURETHANE
11	JOINT: SEAL:	O-RING O-RING		NBR 70 SHORE NBR 70 SHORE

Vitesse Maxi - Top Speed: max 0,5 m/s

Température C° - Temperature C°: -25°C - +80°C

CARACTERISTIQUES TECHNIQUES TECHNICAL SPECIFICATIONS

FORCE DE POUSSEE - OUTPUT FORCE (HTO)

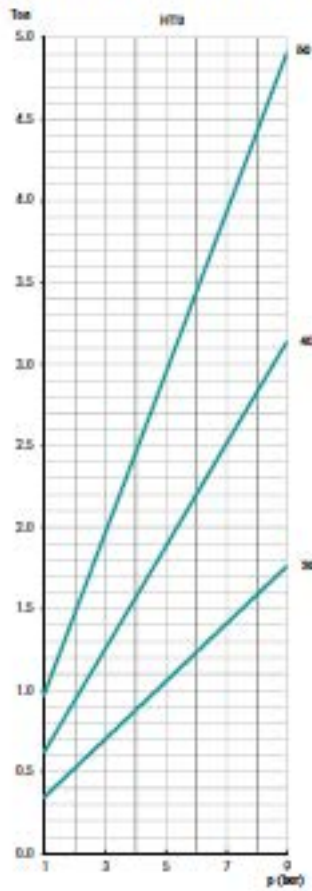

FORCE DE POUSSEE - OUTPUT FORCE (HFRT)

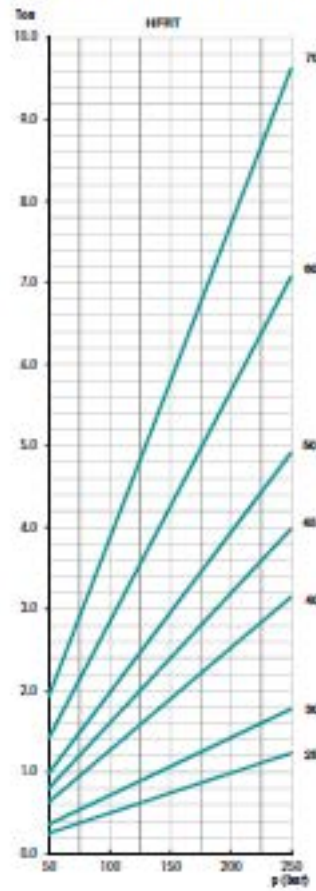

FLAMBAGE - BUCKLING (HTO)

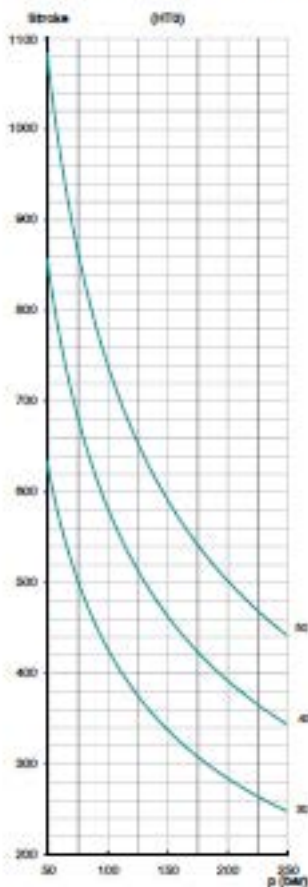

FLAMBAGE - BUCKLING (HFRT)

